

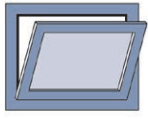

CRANKED TURN-AND-TILT HARDWARE GEZE F 1200
EASE OF USE FOR LARGE AND HEAVY WINDOWS

Cranked turn-and-tilt hardware GEZE F 1200



**Bottom-hung casement
inward-opening**

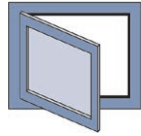

**Side-hung casement
inward-opening**

Operating comfort for heavy and large windows

With the F 1200, GEZE, as a leading manufacturer for decades, offers cranked turn-and-tilt hardware for large scale and heavy windows. The F 1200 meets specific requirements on robustness and stability and satisfies the needs of upscale living comfort – including, for example, thermal isolation and resistance against pelting rain, burglar resistance and, of course, operation suitable for handicapped people. The F 1200 is used in many places – for example in administration buildings, in security-relevant buildings and commercial properties, in hospitals, schools and universities as well as in homes for handicapped people and in comfortable residential buildings.



Europa Center, Berlin, Germany

PRODUCT FEATURES

- Ventilation with variable adjustment – from a small gap to full tilt opening
- High loading capacity
- Functional reliability through cranking mechanism with control indicator, independent of casement weight
Additional mal-operation block and overload friction coupling
- Secure locking by any number of locking studs on all four sides, their closing pressure can be adjusted
- All fitting components are mounted on the inside of the frame, leaving sufficient room for the insulation zone
- Modern assembly technology

Extensive clampable fitting components – comparable to solo tilt-and-turn fittings

CRANKED TURN-AND-TILT HARDWARE GEZE F 1200

GEZE F 1200

All visible parts such as hinges, bearings and gear cover are made of aluminium. All other parts stainless or rust-proof. Surface: silver

- All fitting components – except gears and bearings – are clampable
- The fitting system requires a special framing profile, which can be adapted to the existing cover frames of the different profile series.

EXAMPLES OF RANGES OF APPLICATION



Range of application for aluminium windows

| | |
|--------------------|---|
| Casement width | min. 750 mm max. 2000 mm |
| Casement height | min. 750 mm max. 2500 mm depends on casement weight (glass thickness) |
| Casement weight | up to 200 kg |
| Tilt-opening width | max. 180 mm |

Installation situation: casement in tilted position



Application diagram

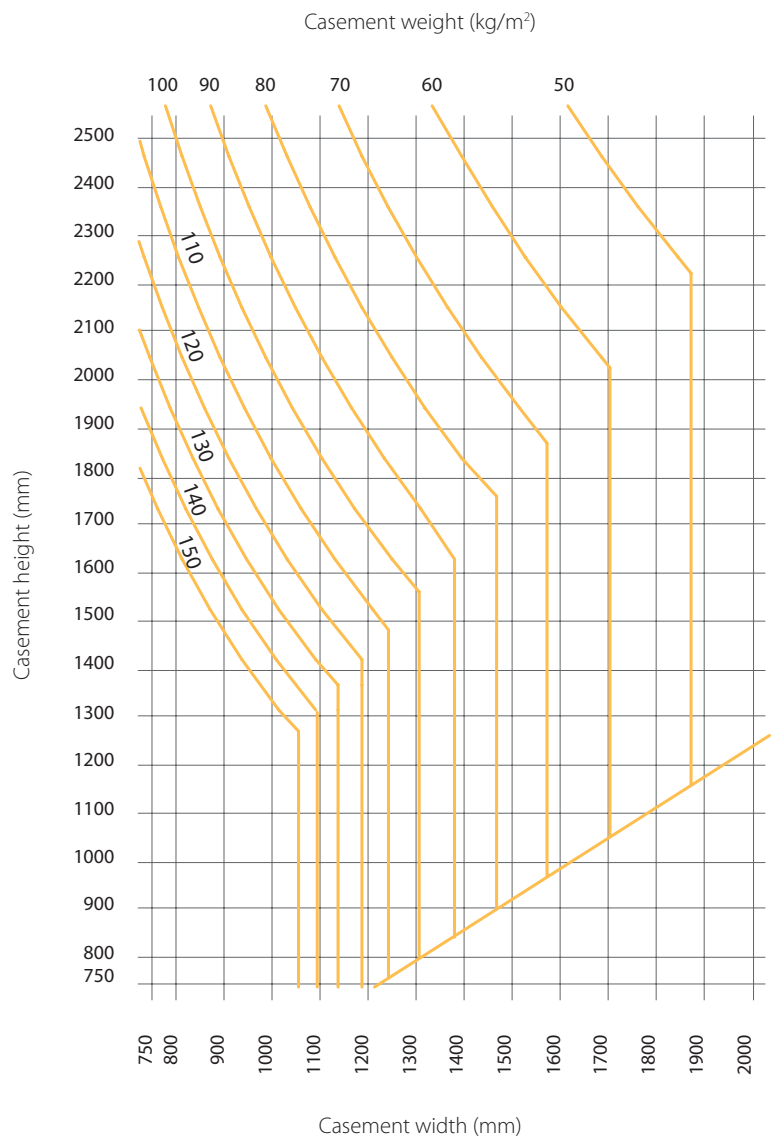

Installation situation: casement in turning position



CRANKED TURN-AND-TILT HARDWARE GEZE F 1200

TECHNICAL DATA

- The F 1200 is operated via a crank gear which is mounted vertically or horizontally on the casement profile and equipped with an overload protection (safety clutch).
- The respective functional position is displayed on a vision panel.
- Via the fold-out crank the casement is either released into the turning position or moved into the tilted position.
- It is possible to adjust every required tilted position.
- The fitting system locks by default in all four corners.
- In addition, depending on the size of the window, almost any number of locking devices can be mounted horizontally or vertically.
- The closing pressure of all locking studs can be adjusted.
- Short installation and processing times are achieved by using mainly clampable and ready-for-assembly fitting units.

INSTALLATION DRAWINGS

Drawing No. 50712-0-001-1 and 50712-0-001-2

Fitting housing for aluminium profile

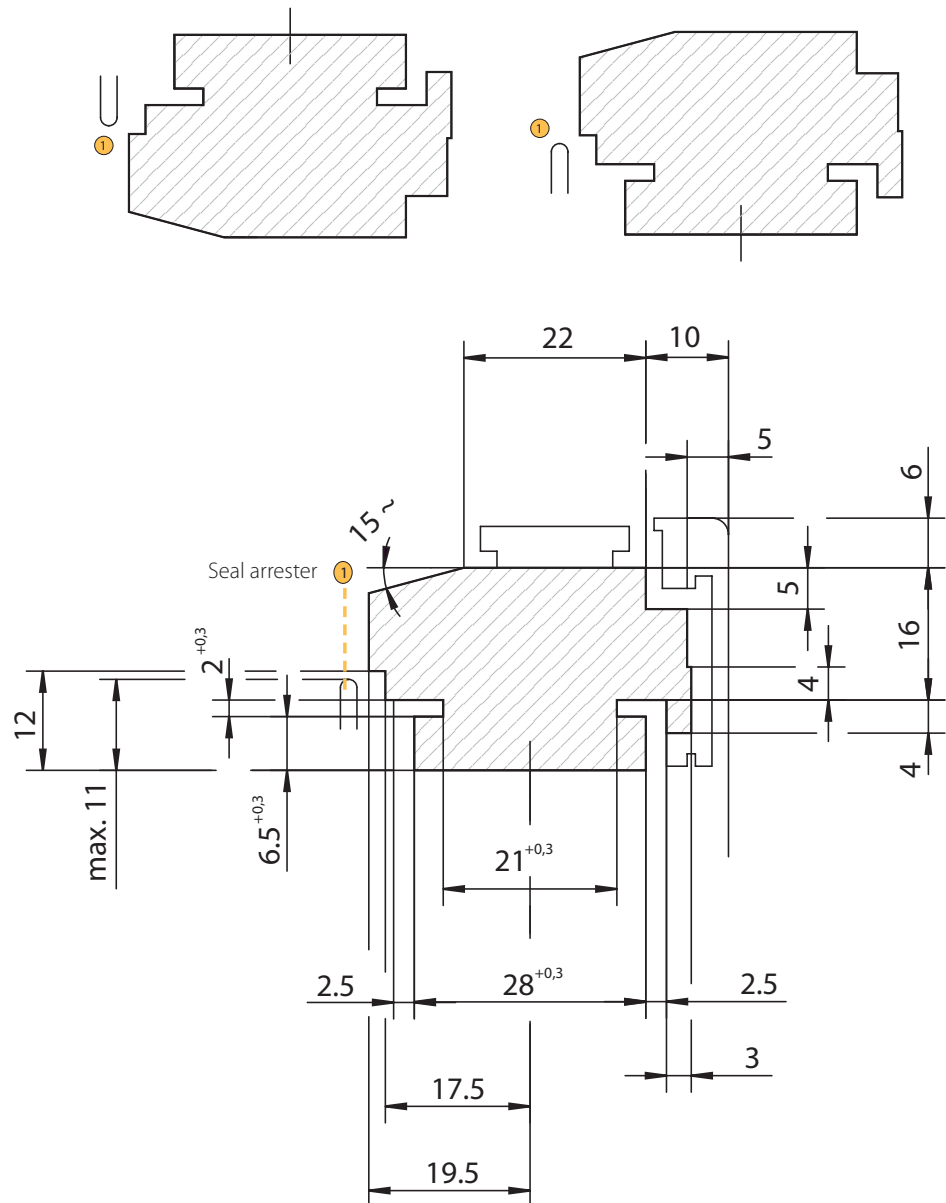

Accessories for cranked turn-and-tilt hardware GEZE F 1200

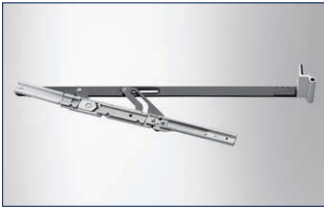

Cross scissor

Cross scissor

The most important functions have been integrated in the cross scissor

- Tilted position can be continuously adjusted, moves smoothly, independent of casement weight
- Secure fixture of window in turning position
- Even if improperly operated, casement does not sag



Crank gear with fold-out crank

Crank gear with fold-out crank

- At the same time, handle for turning position
- Can be mounted variably, either vertical or horizontal
- Easy to use
- Friction coupling to prevent overload
- Display of the respective functional position of the window



Gear with cylinder lock

Gear with lockable turning position via cylinder lock

- Safety equipment
- Special authorisation for turning positions



Gear for detachable crank

Gear for detachable crank

- Safety equipment
- Window operation only possible for authorised persons



Corner transmission

Corner transmission

- Stable spring hinge corner transmission for high functional reliability and power transmission free of clearance



Locking devices

Locking devices

- All-round application
- All locking devices with adjustable pressure (vertical and horizontal central locking device)
- The latch cams are secured with an octagonal wrench against unintentional turning out of position

Accessories for cranked turn-and-tilt hardware GEZE F 1200

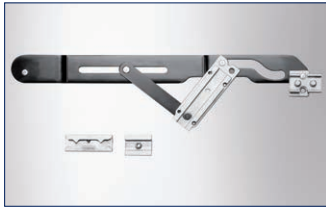

Secondary scissor

Secondary scissor

- For casement widths from 1400 mm
- Operates during the tilting motion synchronously with the scissor opening and gives wider casements more stability



Opening restrictor

Opening restrictor

- Available in several sizes
- For variable limitation of the opening position of the side-hung casement



Mal-operation block

Mal-operation block

- Prevents incorrect operation of the mechanism



Latch lock

Burglar resistance

The following accessories can be used for safeguarding side-hung windows against forced entry:

- Latch lock
- Hooked locking device

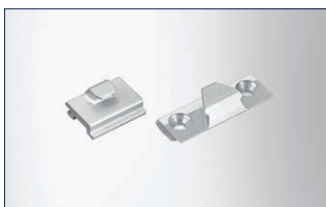

Hooked locking device

CRANKED TURN-AND-TILT HARDWARE GEZE F 1200

ORDER INFORMATION – CRANKED TURN-AND-TILT HARDWARE GEZE F 1200

| Description | Finish | | ID No. |
|---|---|----------------------------------|-----------------------------|
| Basic fittings F 1200 without drive gear, for vertical mounting of the drive | anodised aluminium ¹⁾ | left | 062910 |
| | | right | 062908 |
| Gear F 1200 with crank | anodised aluminium ¹⁾ | left | 063228 |
| | | right | 063226 |
| Gear F 1200 lockable, with crank | anodised aluminium ¹⁾ | left | 063232 |
| | | right | 063230 |
| Gear F 1200 for removable crank (without crank) | anodised aluminium ¹⁾ | left | 063377 |
| | | right | 063375 |
| Removable crank for gear F 1200 | | | 063332 |
| Secondary scissor mechanism F 1200 | | left | 062914 |
| | | right | 062913 |
| Corner transmission F 1200 with accessories for horizontal mounting of the gear ²⁾ | | | 063211 |
| Centre locking F 1200 vertical or horizontal | | | 062912 |
| Opening restrictor F 1200 ³⁾ | not damped | size 0 | 066035 |
| | | size 1 | 066036 |
| | | size 2 | 066037 |
| Burglar resistance F 1200 | Height locking device | | 000330 |
| | Latch lock for overlap from 10 to 11 mm | anodised aluminium ¹⁾ | synchronised closing 001857 |
| | Drilling template, 5-fold | | 063418 |

¹⁾ Customer specified colours are available on request.

²⁾ If horizontal centre locking is used, no corner transmission with accessory parts is required in the case of horizontal gear mounting!

³⁾ The size depends on the casement width.

GEZE GmbH
P.O. Box 1363
71226 Leonberg
Germany

GEZE GmbH
Reinhold-Vöster-Straße 21-29
71229 Leonberg
Germany
Telefon +49 7152 203 0
Telefax +49 7152 203 310
www.geze.com

Germany
 GEZE GmbH
 Niederlassung Süd-West
 Breitwiesenstraße 8
 71229 Leonberg
 Tel. +49 7152 203 594
 Fax +49 7152 203 438
 leonberg.de@geze.com

GEZE GmbH
 Niederlassung Süd-Ost
 Parking 17
 85748 Garching bei München
 Tel. +49 7152 203 6440
 Fax +49 7152 203 77050
 muenchen.de@geze.com

GEZE GmbH
 Niederlassung Ost
 Bühringstraße 8
 13086 Berlin (Weißensee)
 Tel. +49 7152 203 6840
 Fax +49 7152 203 76849
 berlin.de@geze.com

GEZE GmbH
 Niederlassung Mitte/Luxemburg
 Adenauerallee 2
 61440 Oberursel (b. Frankfurt)
 Tel. +49 7152 203 6888
 Fax +49 7152 203 6891
 frankfurt.de@geze.com

GEZE GmbH
 Niederlassung West
 Heltorfer Straße 12
 40472 Düsseldorf
 Tel. +49 7152 203 6770
 Fax +49 7152 203 76770
 duesseldorf.de@geze.com

GEZE GmbH
 Niederlassung Nord
 Haus 11, 1. OG - Theodorstr. 42-90
 22761 Hamburg-Bahrenfeld
 Tel. +49 7152 203 6600
 Fax +49 7152 203 76608
 hamburg.de@geze.com

GEZE Service GmbH
 Niederlassung Süd-West
 Reinhold-Vöster-Straße 25
 71229 Leonberg
 Tel. +49 1802 923392
 Fax +49 7152 9233 359
 service-leonberg.de@geze.com

GEZE Service GmbH
 Niederlassung Süd
 Parking 17
 85748 Garching bei München
 Tel. +49 1802 923392
 Fax +49 7152 9233 859
 service-muenchen.de@geze.com

GEZE Service GmbH
 Niederlassung Mitte
 Oberurseler Str. 69
 61440 Oberursel
 Tel. +49 1802 923392
 Fax +49 7152 9233 659
 service-oberursel.de@geze.com

GEZE Service GmbH
 Niederlassung West
 Heltorfer Straße 12
 40472 Düsseldorf
 Tel. +49 1802 923392
 Fax +49 7152 9233 559
 service-duesseldorf.de@geze.com

GEZE Service GmbH
 Niederlassung Nord-Ost
 Bühringstraße 8
 13086 Berlin (Weißensee)
 Tel. +49 1802 923392
 Fax +49 7152 9233 759
 service-berlin.de@geze.com

GEZE Service GmbH
 Niederlassung Nord
 Theodorstr. 42-90, Haus 11
 22761 Hamburg
 Tel. +49 1802 923392
 Fax +49 7152 9233 459
 service-hamburg.de@geze.com

Austria
 GEZE Austria
 Wiener Bundesstrasse 85
 A-5300 Hallwang
 Tel: +43 6225 87180
 Fax: +43 6225 87180 299
 austria.at@geze.com

Baltic States
 GEZE GmbH Baltic States office
 Dzelzavas iela 120 S
 1021 Riga
 Tel. +371 678960 35
 Fax +371 678960 36
 office-latvia@geze.com

Benelux
 GEZE Benelux B.V.
 Industrierrein Kapelbeemd
 Steenoven 36
 5626 DK Eindhoven
 Tel. +31 4026290 80
 Fax +31 4026290 85
 benelux.nl@geze.com

Bulgaria
 GEZE Bulgaria - Trade
 Representative Office
 Nickolay Haitov 34 str., fl. 1
 1172 Sofia
 Tel. +359 247043 73
 Fax +359 247062 62
 office-bulgaria@geze.com

China
 GEZE Industries (Tianjin) Co., Ltd.
 Shuangchenzhong Road
 Beichen Economic Development
 Area (BEDA)
 Tianjin 300400, P.R. China
 Tel. +86 22 26973995
 Fax +86 22 26972702
 chinasales@geze.com.cn

GEZE Industries (Tianjin) Co., Ltd.
 Branch Office Shanghai
 Jia Little Exhibition Center
 Room C 2-102
 Shenzhuan Rd. 6000
 201619 Shanghai, P.R. China
 Tel. +86 21 52340960
 Fax +86 21 64472007
 chinasales@geze.com.cn

GEZE Industries (Tianjin) Co., Ltd.
 Branch Office Guangzhou
 Room 17 C 3
 Everbright Bank Building, No.689
 Tian He Bei Road
 510630 Guangzhou, P.R. China
 Tel. +86 20 38731842
 Fax +86 20 38731834
 chinasales@geze.com.cn

GEZE Industries (Tianjin) Co., Ltd
 Branch Office Beijing
 Room 1001, Tower D
 Sanlitun SOHO
 No. 8, Gongti North Road,
 Chaoyang District
 100027 Beijing, P.R.China
 Tel. +86 10 59359300
 Fax +86 10 59359322
 chinasales@geze.com.cn

France
 GEZE France S.A.R.L.
 ZAC de l'Orme Rond
 RN 19
 77170 Servon
 Tel. +33 1 606260 70
 Fax +33 1 606260 71
 france.fr@geze.com

Hungary
 GEZE Hungary Kft.
 Hungary-2051 Biatorbágy
 Vendel Park
 Huber u. 1.
 Tel. +36 23532 735
 Fax +36 23532 738
 office-hungary@geze.com

Iberia
 GEZE Iberia S.R.L.
 C/ Andorra 24
 08830 Sant Boi de Llobregat
 (Barcelona)
 Tel. +34 902194 036
 Fax +34 902194 035
 info@geze.es

India
 GEZE India Private Ltd.
 MF 2 & 3, Guindy Industrial Estate
 Ekkattuthangal
 Chennai 600 097
 Tamilnadu
 Tel. +91 44 406169 00
 Fax +91 44 406169 01
 office-india@geze.com

Italy
 GEZE Italia S.r.l
 Sede di Milano
 Via Giotto 4
 20040 Cambiago (MI)
 Tel. +39 0295069 511
 Fax +39 0295069 533
 italia.it@geze.com

Sede di Roma
 Via Lucrezia Romana, 91
 00178 Roma
 Tel. +39 06 726531 1
 Fax +39 06 726531 36
 roma@geze.biz

Poland
 GEZE Polska Sp.z o.o.
 ul. Annapol 21
 03-236 Warszawa
 Tel. +48 224 404 440
 Fax +48 224 404 400
 geze.pl@geze.com

Romania
 GEZE Romania S.R.L.
 IRIDE Business Park,
 Str. Dimitrie Pompeiu nr. 9-9a,
 Building 10, Level 2, Sector 2,
 020335 Bucharest
 Tel.: +40 212507 750
 Fax: +40 316201 258
 office-romania@geze.com

Russia
 OOO GEZE RUS
 Gamsonovskiy Per. 2
 115191 Moskau
 Tel. +7 495 93306 59
 Fax +7 495 93306 74
 office-russia@geze.com

Scandinavia – Sweden
 GEZE Scandinavia AB
 Mallslingan 10
 Box 7060
 18711 Täby, Sweden
 Tel. +46 87323 400
 Fax +46 87323 499
 sverige.se@geze.com

Scandinavia – Norway
 GEZE Scandinavia AB avd. Norge
 Industriveien 34 B
 2073 Dal
 Tel. +47 63957 200
 Fax +47 63957 173
 norge.se@geze.com

Scandinavia – Denmark
 GEZE Danmark
 Branch office of GEZE Scandinavia AB
 Mårkærvej 13 J-K
 2630 Taastrup
 Tel. +45 463233 24
 Fax +45 463233 26
 danmark.se@geze.com

Singapore
 GEZE (Asia Pacific) Pte. Ltd.
 21 Bukit Batok Crescent
 #23-75 Wcega Tower
 Singapore 658065
 Tel: +65 6846 1338
 Fax: +65 6846 9353
 gezessea@geze.com.sg

South Africa
 GEZE Distributors (Pty) Ltd.
 118 Richards Drive, Halfway House,
 Ext 111, P.O. Box 7934, Midrand 1685,
 South Africa
 Tel: + 27 113158 286
 Fax: + 27 113158 261
 info@gezesa.co.za

Switzerland
 GEZE Schweiz AG
 Zeliglimatte 1A
 6260 Reiden
 Tel. +41 62 28554 00
 Fax +41 62 28554 01
 schweiz.ch@geze.com

Turkey
 GEZE Kapı ve Pencere Sistemleri
 San. ve Tic. Ltd. Sti.
 İstanbul Anadolu Yakası Organize
 Sanayi Bölgesi
 Gazi Bulvarı Caddesi 8.Sokak No:8
 Tuzla-İstanbul
 Tel. + 90 216 45543 15
 Fax + 90 216 45582 15
 office-turkey@geze.com

Ukraine
 LLC GEZE Ukraine
 ul. Viskoznaya, 17,
 Building 93-B, Office 12
 02660 Kiev
 Tel./Fax +38 445012225
 office-ukraine@geze.com

United Arab Emirates/GCC
 GEZE Middle East
 P.O. Box 17903
 Jebel Ali Free Zone
 Dubai
 Tel. +971 48833 112
 Fax +971 48833 240
 gezeme@geze.com

United Kingdom
 GEZE UK Ltd.
 Blenheim Way
 Fradley Park
 Lichfield
 Staffordshire WS13 8SY
 Tel. +44 15434430 00
 Fax +44 15434430 01
 info.uk@geze.com

GEZE REPRESENTATIVE